



THE Waterford

COMMUNITIES  
Assisted Living & Memory Care



About this location

## The Waterford at Wilderness Hills Memory Care

The Waterford at Wilderness Hills Memory Care is tucked in the luxurious Wilderness Hills neighborhood. This 16-apartment community is locally owned and operated, and offers highly specialized Alzheimer's, Dementia, and Memory Care. You will have peace of mind knowing you or your loved one is safe, secure, and enjoying the many benefits of our newest community that feels like home. We have the unique opportunity to specially individualize your care due to our small size, which is what sets us apart. We are passionate about discovering each of our residents' interests and abilities, which allows them to thrive in a personalized environment.

### Community Benefits & Perks

#### ✓ Basic Needs

- 24 hr Monitored, Secured Facility
- High Staff-to-Resident Ratio
- Family Style Dining Experience
- Weekly Housekeeping & Laundry Services
- 3 Home Cooked Meals + Snacks

#### 💊 Medical Needs

- Medication Administration
- Personal Care & Hygiene Assistance
- On-Site Physician Services
- Emergency Call System
- Home Health & Hospice Partnerships
- 24 hr Licensed Care Team & RN Supervision

#### 👍 Community Perks

- Secured Patio, Walking Path & Courtyard
- Pet-Friendly
- Complimentary WiFi & Cable TV
- On-Site Beauty and Barber Shop

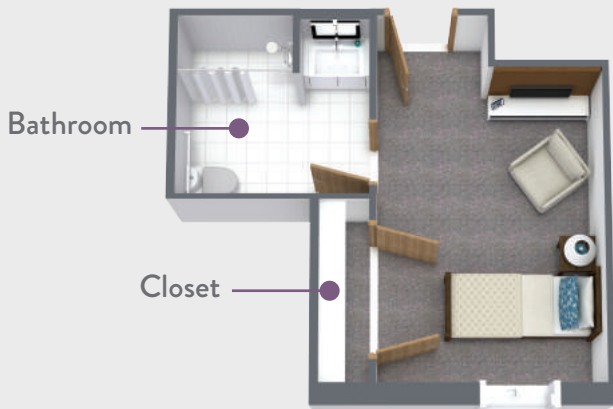

### Wilderness Hills Studio

Private Studio Apartment: \$6,200

#### Level of Care Costs:

Level 1: Included | Level 2: \$400 | Level 3: \$900

Diabetic Care: \$200/month

Respite Care: \$230/day

Deposit: \$1,800 (non-refundable after move-in)

Pet Deposit: \$900 + \$100/month fee

### Contact The Waterford at Wilderness Hills!

#### Address

8939 Keystone Drive  
Lincoln, NE 68516

#### Phone/Fax

P: (402) 421-8105  
F: (402) 421-8106

#### Visit us at:

Email: [home@thewaterford.net](mailto:home@thewaterford.net)  
Website: [www.thewaterford.net](http://www.thewaterford.net)

Wilderness Hills